



“Making **YOU** stand out”

**ASSEMBLY GUIDE**

*for*

**Sliq Media**

**10' x 10'**

*Update: 2016-3497  
March 2017*

ExpoSystems Canada  
Toll-Free Assistance:  
1-800-263-3976

# Packing Guidelines

---

- All panels with pins must be packed **pins up**.
- Graphics must be rolled **face out** and placed in either box provided or cardboard pocket (pocket for flat graphics).
- Any brackets for audio-visual equipment must be **removed from panels** prior to packing in case.
- Protective cardboard sheets must be placed **between each panel**.
- For rental units, all hardware and keys must be **returned with the exhibit**.
- Any lighting with the exhibit must be either **packed in the boxes provided** or **wrapped in bubble wrap with the cords neatly coiled**.
- All panel joiners must be **removed from panels**.
- All panel joiners must be either **shrink wrapped together in groups of four** or **bubble wrapped**.
- Failure to follow these instructions will result in damage to the exhibit. (Note: For rental exhibits, *any damages will be billed at the cost of the installation company.*)



*Fully assembled display.*

# Contents

---

<b>Isometric View</b>	<b>2</b>
<b>Plan View</b>	<b>3</b>
<b>Front View</b>	<b>4</b>
<b>General Assembly Guidelines</b>	<b>5</b>
<b>Exploded View</b>	<b>8</b>

# Isometric View

D3

2016-3497

10' x 10' ExpoProfile Booth

Slit Media

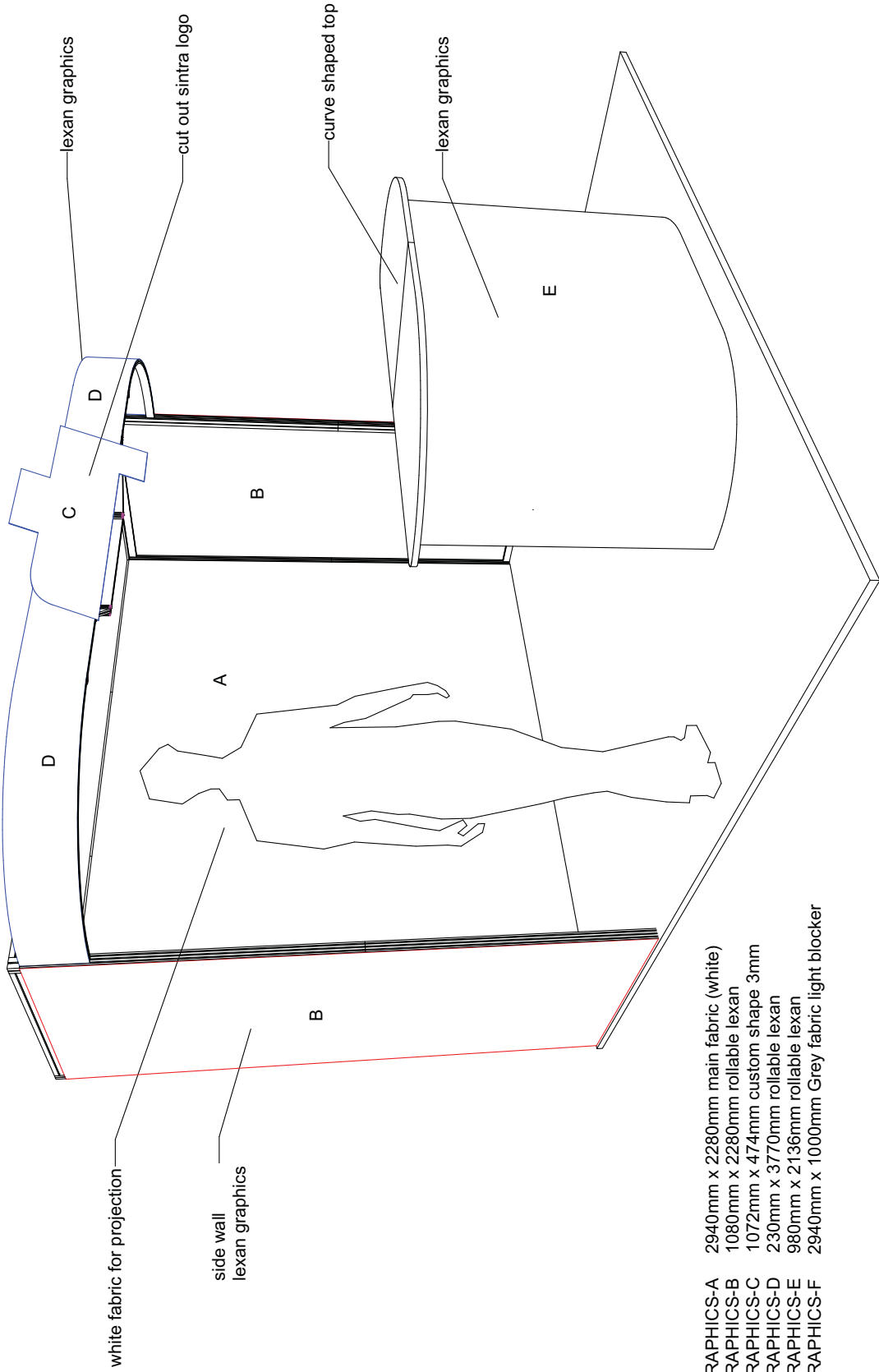

- !RAPHICS-A 2940mm x 2280mm main fabric (white)
- !RAPHICS-B 1080mm x 2280mm rollable lexan
- !RAPHICS-C 1072mm x 474mm custom shape 3mm
- !RAPHICS-D 230mm x 3770mm rollable lexan
- !RAPHICS-E 980mm x 2136mm rollable lexan
- !RAPHICS-F 2940mm x 1000mm Grey fabric light blocker

Start Date: Dec 20, 2016    Revised: Jan 19, 2017    Account Rep: Josh    Designer: IF/RL

Copyright © 2010 ExpoSystems Canada. All rights reserved. This information, designs and printed materials on this page may not be reproduced, republished or duplicated without written permission from ExpoSystems Canada.



**ExpoSystems**  
CANADA  
Displays and Exhibits  
www.exposystems.com

# Plan View

Sliq Media 2016-3497 D3 10' x 10' ExpoProfile Booth

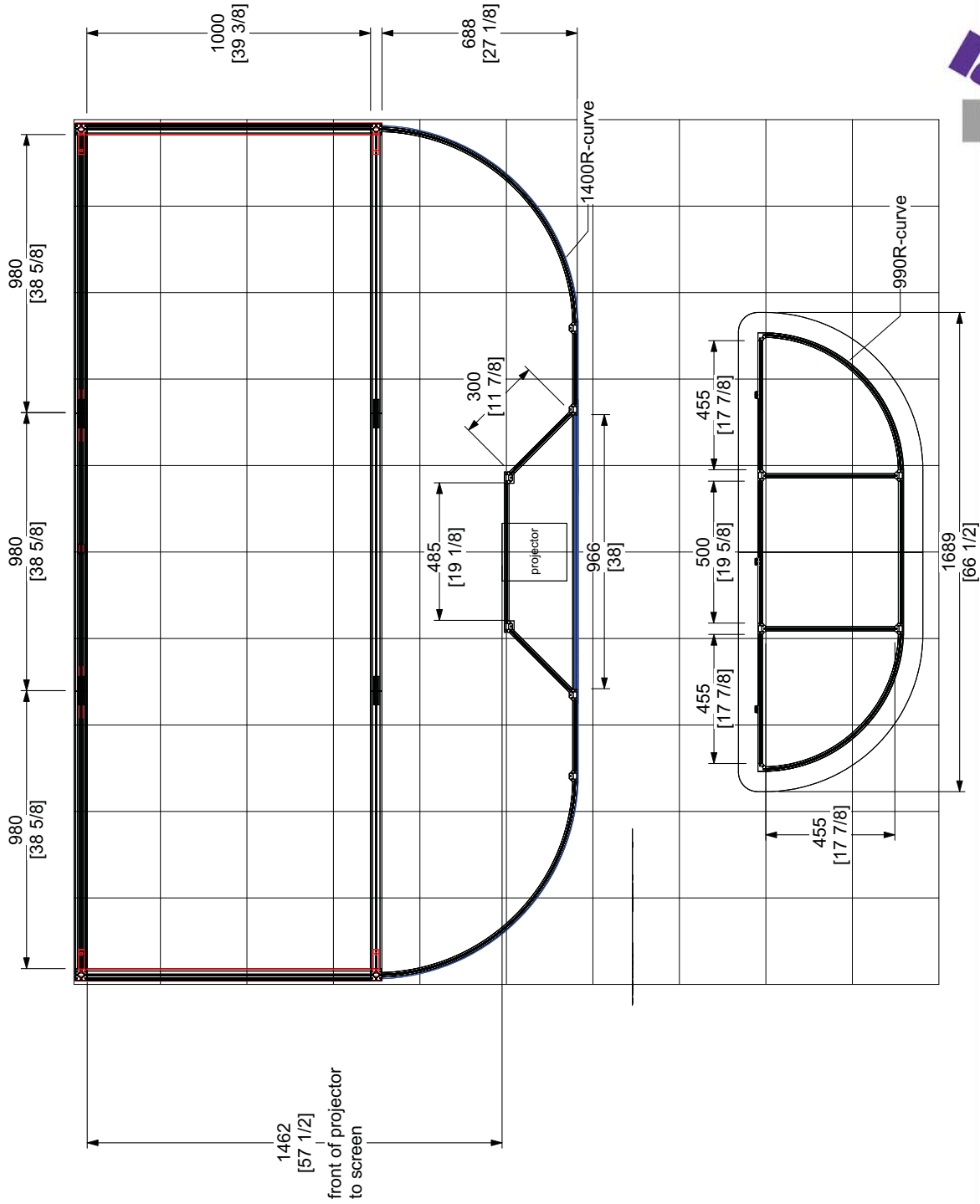

# Front View

D 3

2016-3497

10' x 10' ExpoProfile Booth

Sliq Media

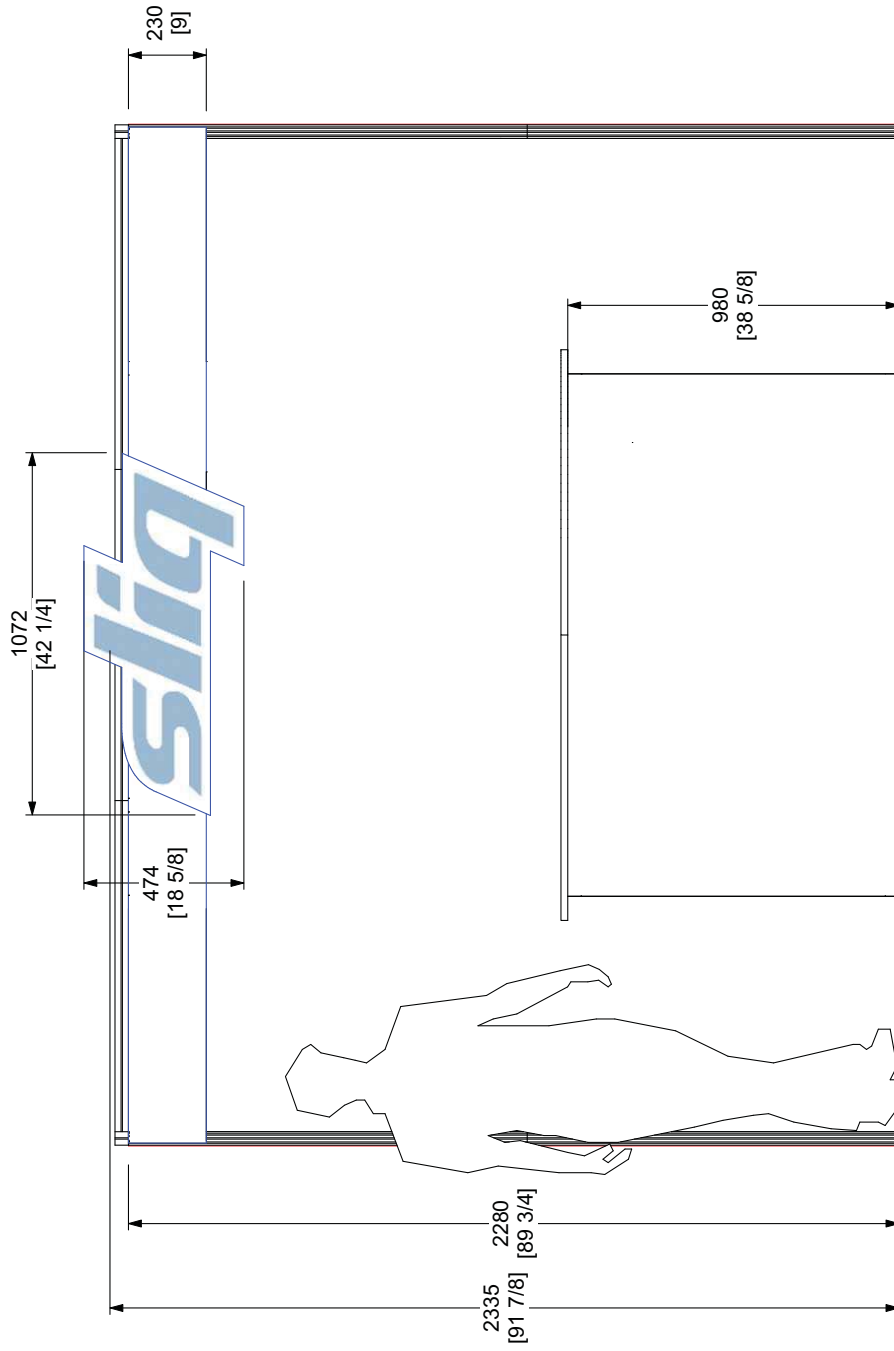

Start Date: Dec 20, 2016

Revised: Jan 19, 2017

Account Rep: Josh

Designer: IF/RL

Copyright © 2010 ExpoSystems Canada. All rights reserved. The information, designs and printed materials on this page may not be reproduced, republished or duplicated without written permission from ExpoSystems Canada.

# General Assembly Guidelines

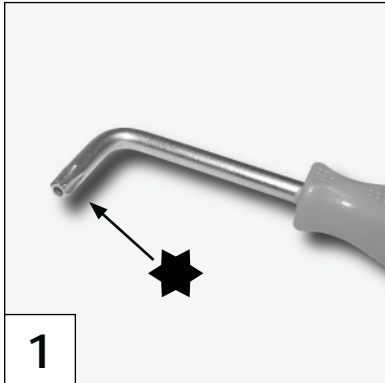

1. ExpoProfile® components are attached via a star-type Torx® key wrench. (Note: Hex-type wrenches are not suitable for installation.)

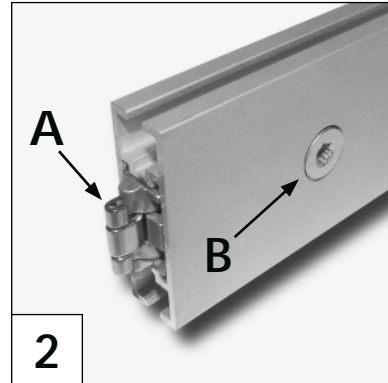

2. ExpoProfile® crossrails connect to the vertical posts by their claws at the rail ends (A), which are adjusted by inset screws at the sides (B).

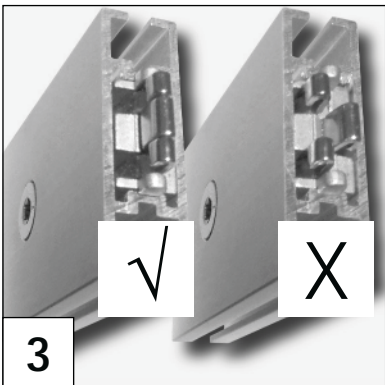

3. Before fitting the rails to the posts, make sure that the claws are closed (left) and *not* opened (right).

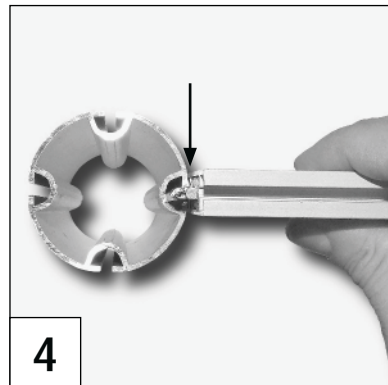

4. The posts have vertical grooves which run along their lengths. Insert the crossrail claw into the post groove until the rail butts up flush...

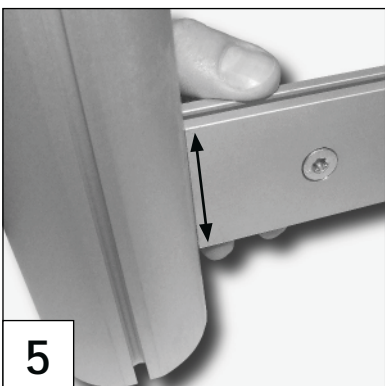

5. ...then slide the rail along the post groove until the correct height is reached.

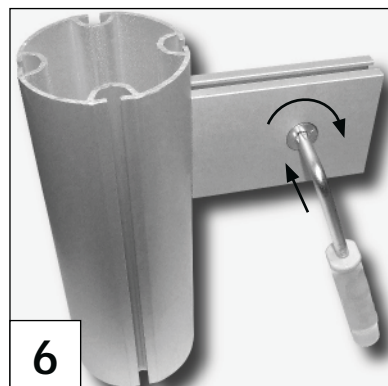

6. Insert the Torx® wrench into the side inset screw, then lock the claws inside the post grooves with a 1/4-1/2 turn of the screw. (Note: Tighten the screw only until snug- **DO NOT OVERTIGHTEN.**)

# General Assembly Guidelines

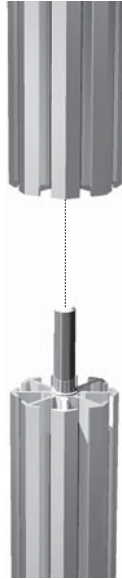

## **POST SPIGOT INSERTION**

The post sections are attached by spigot inserts which slide into the upper pieces. When extra reinforcement is needed, connectors are used which slip into the vertical post grooves and are secured with set screws. (Note: tighten only until snug- *Do not overtighten.*)

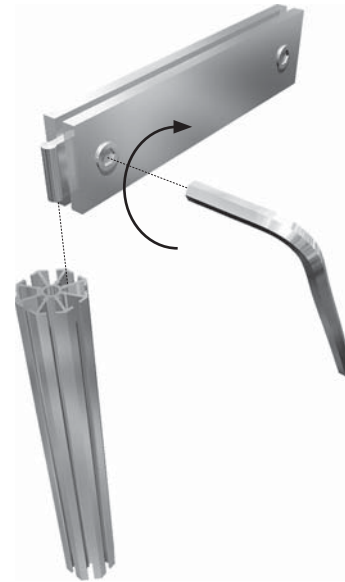

## **POST/RAIL ASSEMBLY**

To attach the rail sections to the vertical posts, first insert the clawed ends of the rails into the vertical slots of the posts. After adjusting to the correct height, insert the supplied key wrench into the rail end screw sockets, and secure with a 1/4 - 1/2 clockwise turn of the screw. (Note: tighten only until snug- *Do not overtighten.*)

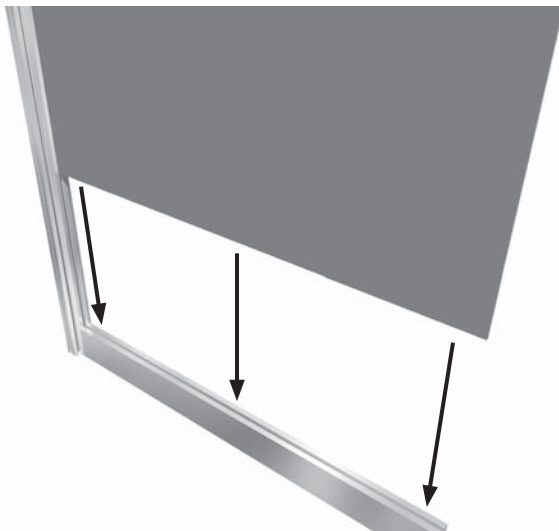

## **PANEL INSERTION**

The panels slide into grooves along the edges of the posts and crossrails. When fitting, always make sure that they are properly seated in these grooves.



## **2-PIECE RAIL CONNECTION**

Split rails are joined at the seam by rectangular connectors which slide into the center rail cavity, and are then secured with screws at each rail end. (Note: tighten only until snug- *Do not overtighten.*)

# General Assembly Guidelines

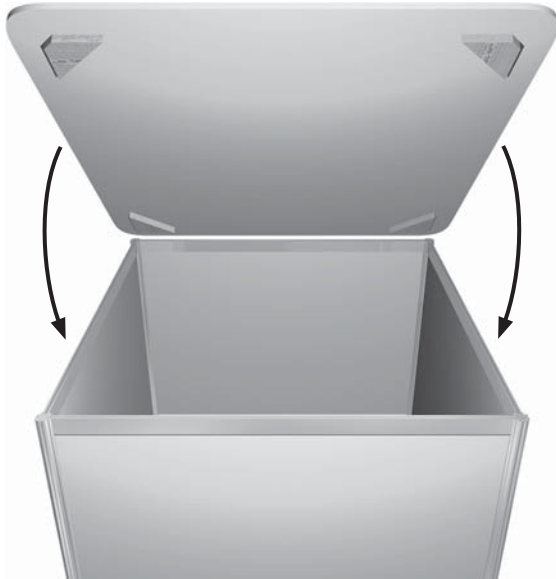

**COUNTER TOPS**

Counter tops simply sit on top of the counter panels. Guide blocks on the underside help to keep them seated.

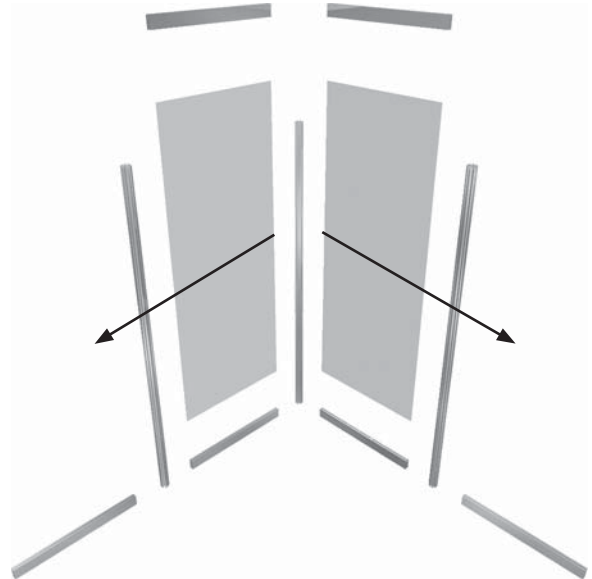

**ASSEMBLY ORDER**

To ensure stability, it is best to assemble the unit from the corners and work outwards.



**FABRIC GRAPHIC ATTACHMENT**

Fabric graphics tuck into the side opening of the fabric channel (channel is first slid into the groove of the post).

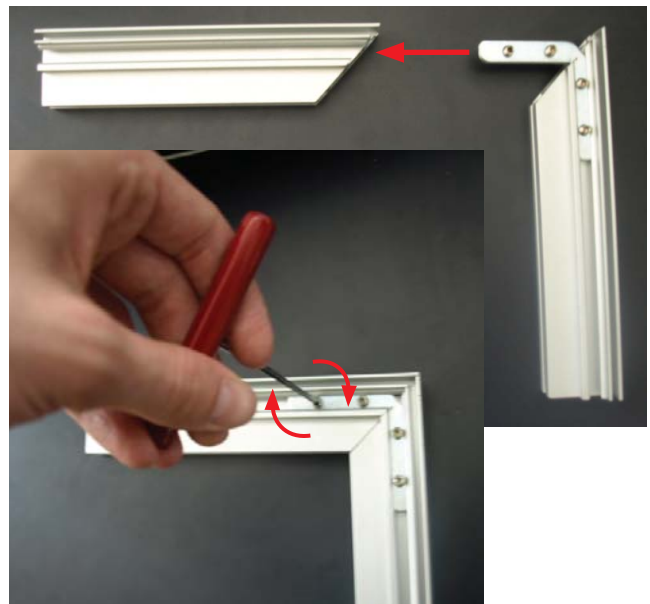

**CORNER BRACKET ATTACHMENT**

Corner Bracket to be tightened with allen key(channel is first slid into the groove of the post).

# Exploded View

## Assembly 1

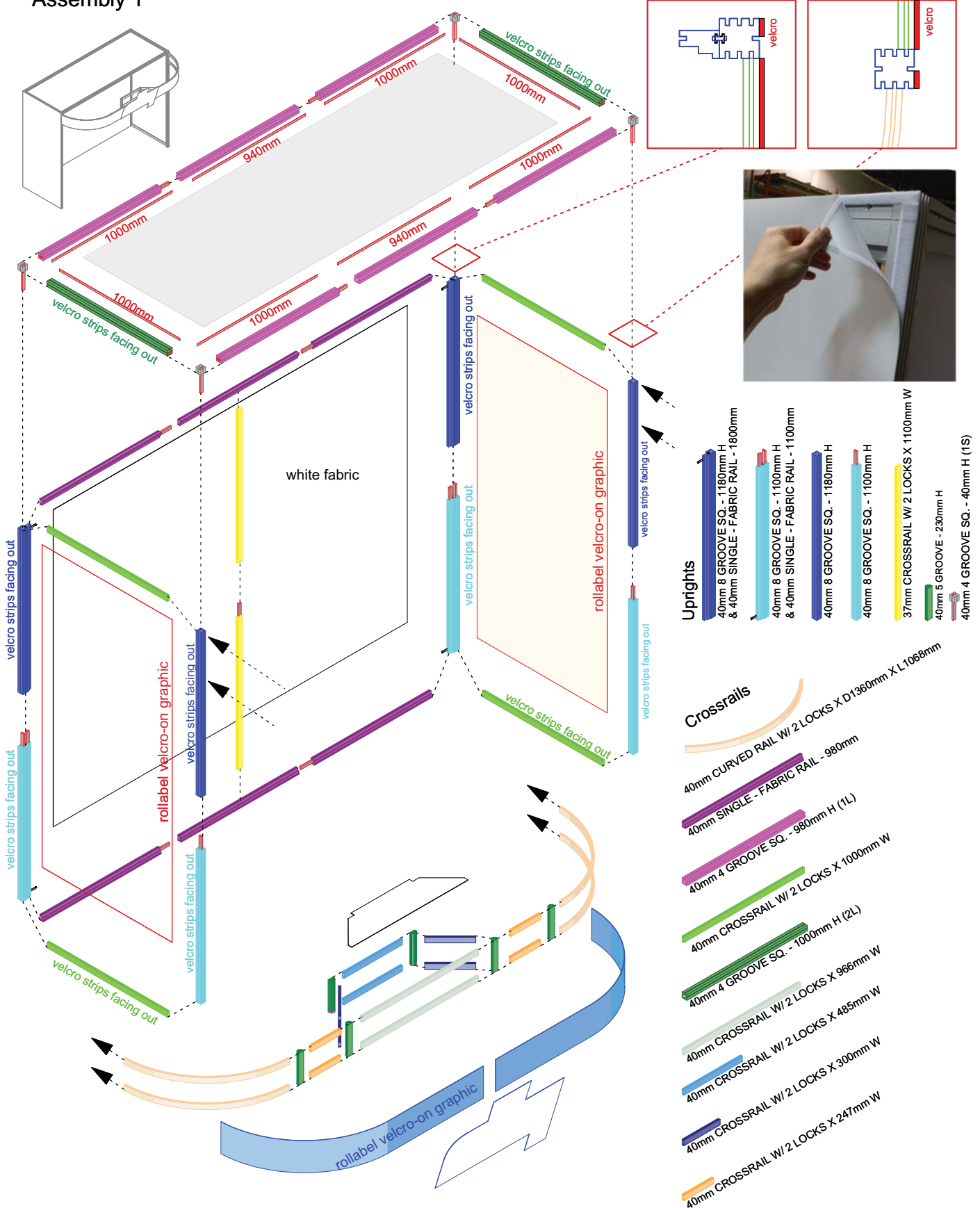

# Exploded View

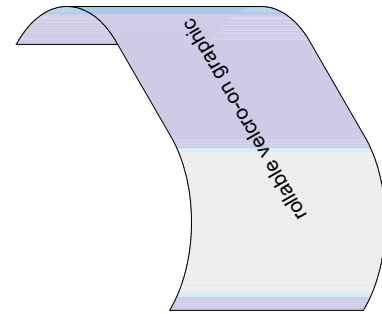
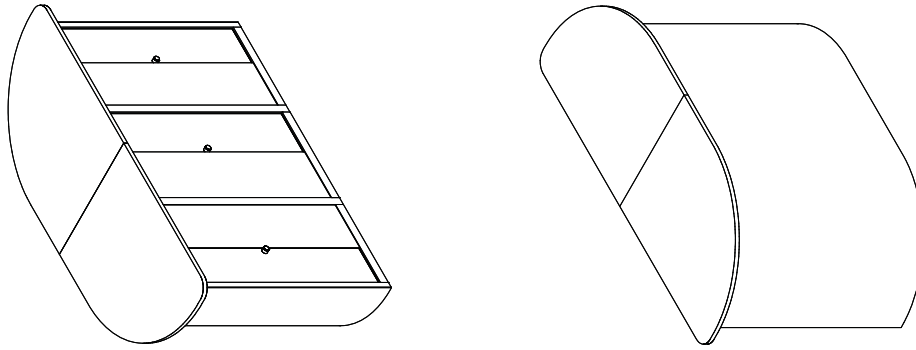

**Uprights**  
28mm - CORNER SQUARE 980mm H  
40mm 5 GROOVE - 0980mm H

**Rails**  
40mm CURVED RAIL W/ 2 LOCKS X 455mm W  
40mm CROSSRAIL W/ 2 LOCKS X 455mm W  
40mm CROSSRAIL W/ 2 LOCKS X 500mm W  
40mm CROSSRAIL W/ 2 LOCKS X 980mm X 175mm

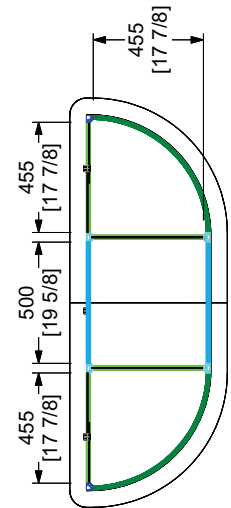
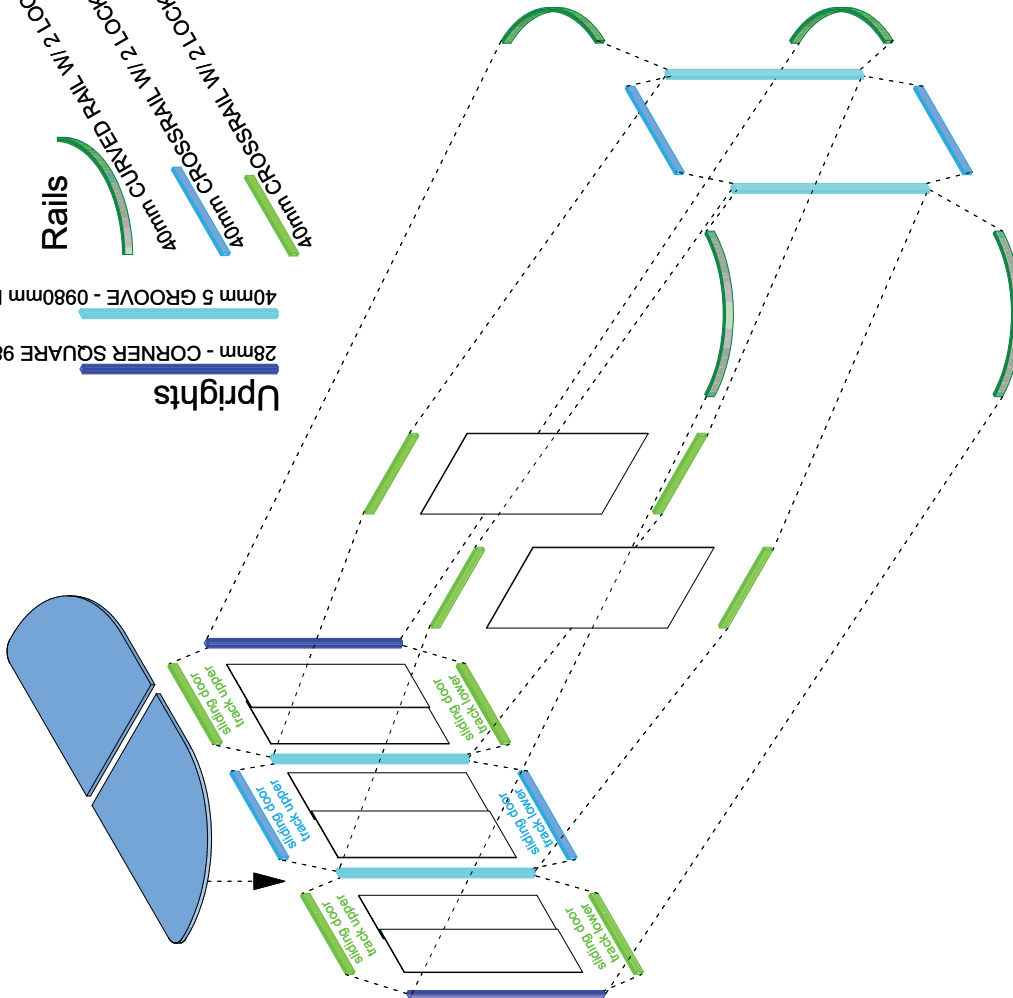

Counter

# Photos





ExpoSystems Canada (Div. McNicoll Stevenson Ltd.)  
3640B McNicoll Avenue, Scarborough, Ontario, Canada M1X 1G5  
Tel. (416) 291-2932 Fax (416) 291-0383  
[www.exposystems.com](http://www.exposystems.com)