

Setup Instructions

Altitude Exhibits

Contact: Jeremy Luther

Project #: 102986-V1

Order #: 0566441

Ship Date: 01.28.2015

Designer: Jason Done

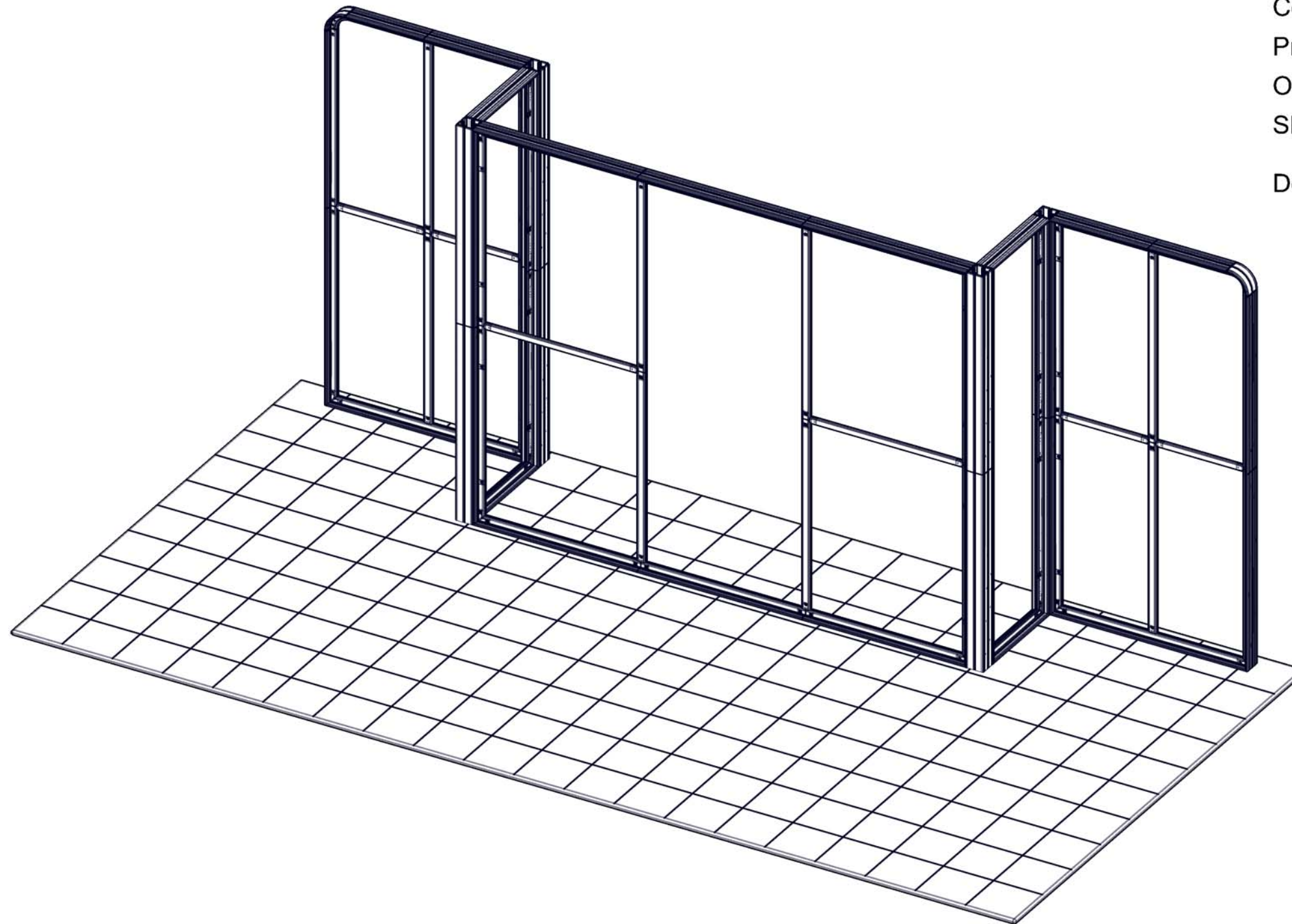

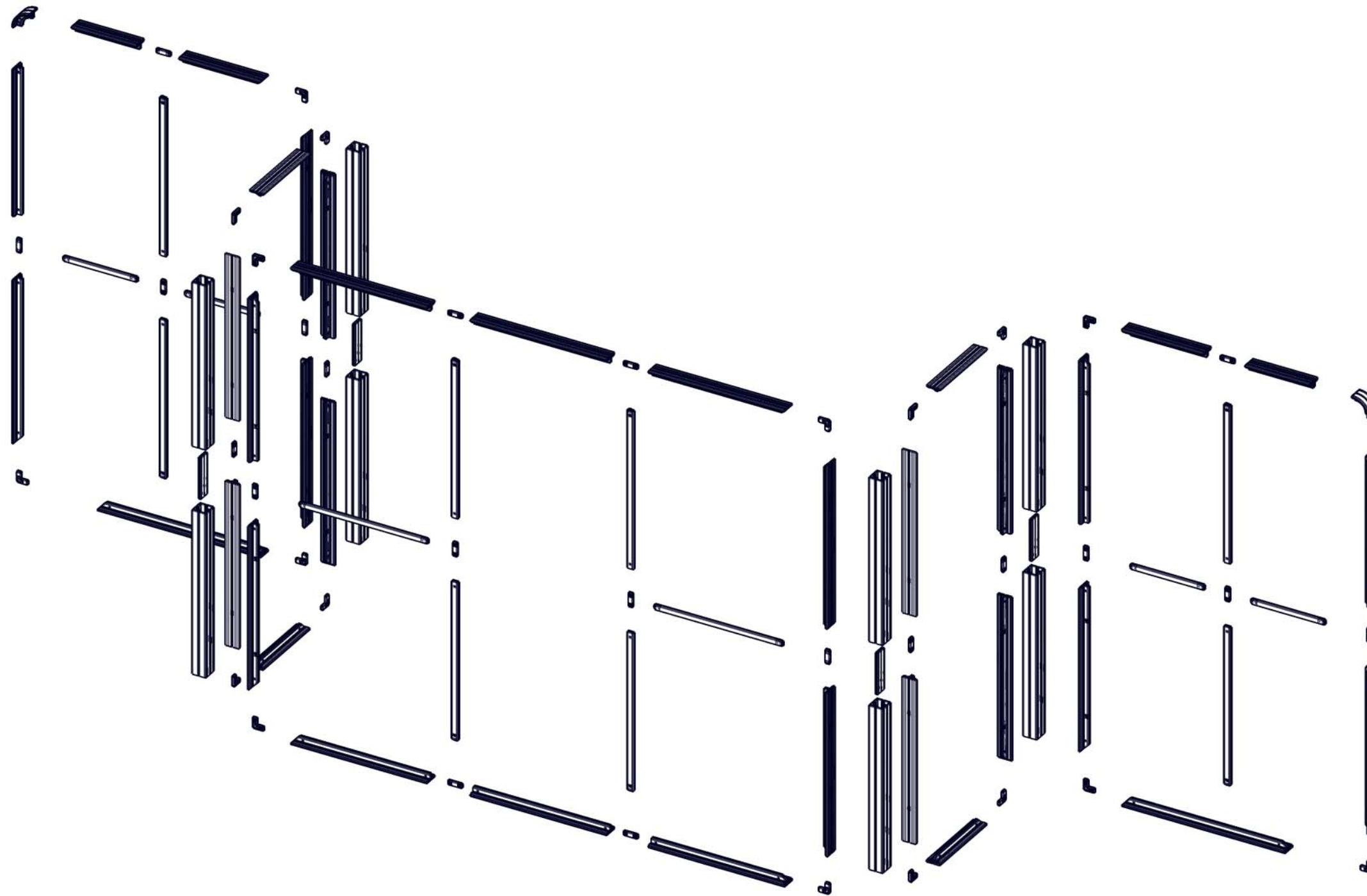

QTY	CODE	DESCRIPTION
18	CB9	90 degree joiner
2	CB9R100	100MM RADIUS CONNECTOR FOR PHFC4 EXTRUSION
2	CB9R100-WINGS	100MM RADIUS CONNECTOR PLASTIC WINGS WITH SCREWS FOR PHFC4
20	IB2	Joiner Bar(new design)
8	PH-1155-L1-L	1155MM LENGTH OF PH EXTRUSION-WITH IB2 LOCK HOLES ONE SIDE-C
4	PH1-532-S-S	532MM-PH1 EXTRUSION CUT DOWN FROM 600MM-WITH SLIDE LOCK BOTH SIDES
2	PH1-932-S-S	932MM-PH1 EXTRUSION CUT DOWN FROM 1000MM-WITH SLIDE LOCK BOTH SIDES
4	PH2SC-300	300MM LENGTH OF PH2 EXTRUSION WITH TENSION GLIDES
2	PHFC4-1000-L1-L1	1000MM LENGTH OF PHFC4 EXTRUSION-WITH IB2 LOCK HOLES BOTH
4	PHFC4-1000-MCB9-L1	1000MM LENGTH OF PHFC4 EXTRUSION-WITH MITRE CUT FOR CB9 ONE
2	PHFC4-1075-L1-L	1075MM-PHFC4 EXTRUSION CUT DOWN FROM 1200MM-WITH IB2 LOCK HOLES ONE END-CAM LOCK ONE END
2	PHFC4-1200-MCB9-L1	1200MM LENGTH OF PHFC4 EXTRUSION-WITH MITRE CUT FOR CB9 ONE END-IB2 LOCK HOLES ONE END
16	PHFC4-1200-MCB9-L1-SIDE	1200MM LENGTH OF PHFC4 EXTRUSION-WITH MITRE CUT FOR CB9 ONE
2	PHFC4-1200-MCB9-MCB9	1200MM LENGTH OF PHFC4 EXTRUSION-WITH MITRE CUT FOR CB9 BOTH ENDS
2	PHFC4-475-L1-L	475MM-PHFC4 EXTRUSION CUT DOWN FROM 600MM-WITH IB2 LOCK HOLES ONE END-CAM LOCK ONE END
2	PHFC4-600-MCB9-L1	600MM LENGTH OF PHFC4 EXTRUSION-WITH MITRE CUT FOR CB9 ONE END-IB2 LOCK HOLES ONE END
4	PHFC4-600-MCB9-MCB9	600MM LENGTH OF PHFC4 EXTRUSION-WITH MITRE CUT FOR CB9 BOTH ENDS
8	PM4S2-1200-A	1200MM LENGTH OF PM4S2 EXTRUSION-WITH STOPS ONE END

1. Redesign of this exhibit without approval by Manufacturer may result in dangerous and unsafe structures. Manufacturer disclaims any responsibility for redesigned exhibits it does not approve in writing.

2. Parts and components such as panels and extrusions are manufactured to metric sizing. Where ever possible sizes have been noted in feet and inches as well as in metric. Below is the imperial to metric sizing table as reference. "Nominal" refers to approximate size.

ASSEMBLE FRAME

SECTION A

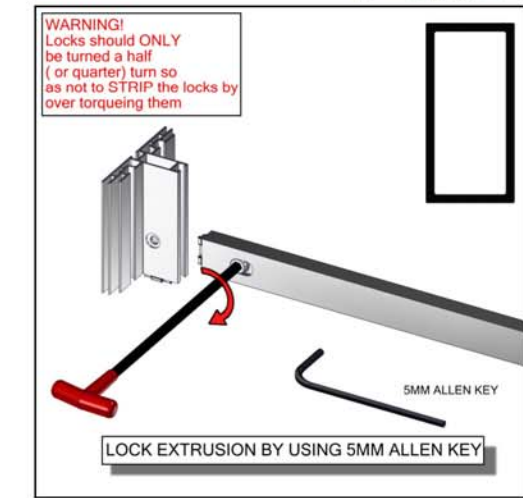
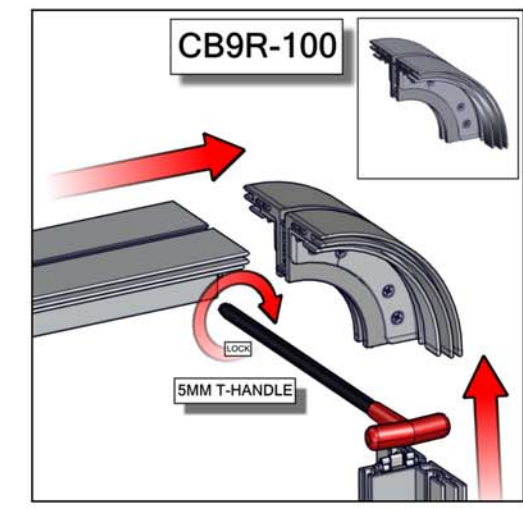
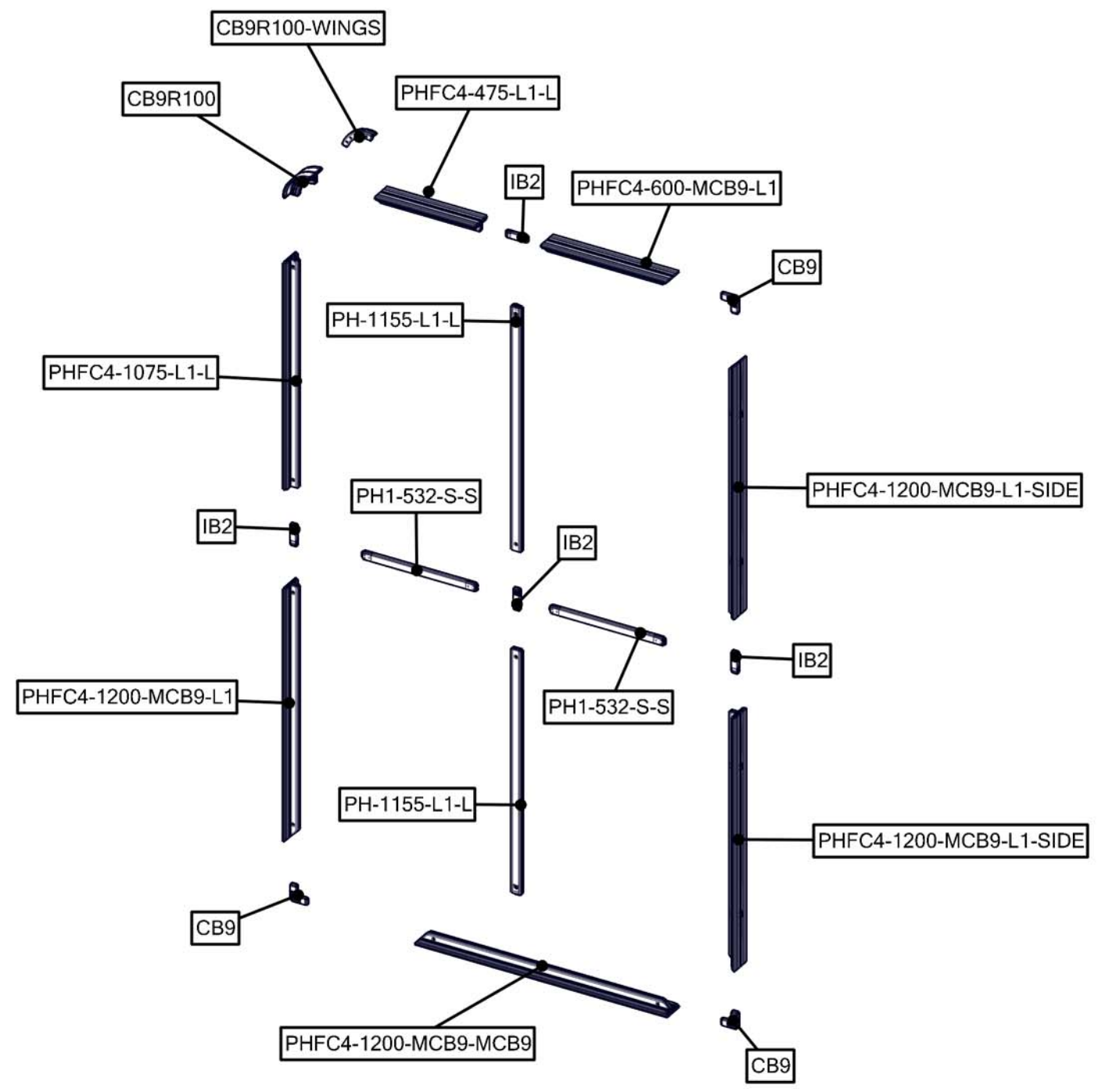

WARNING!
Locks should ONLY be turned a half (or quarter) turn so as not to STRIP the locks by over torquing them

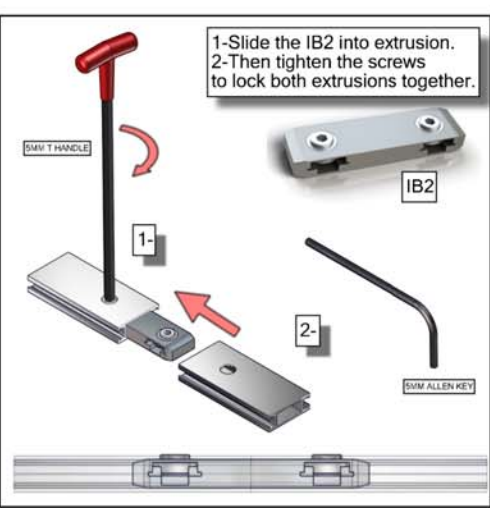
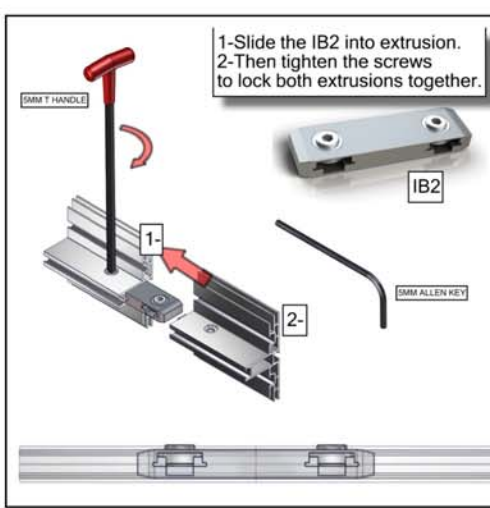
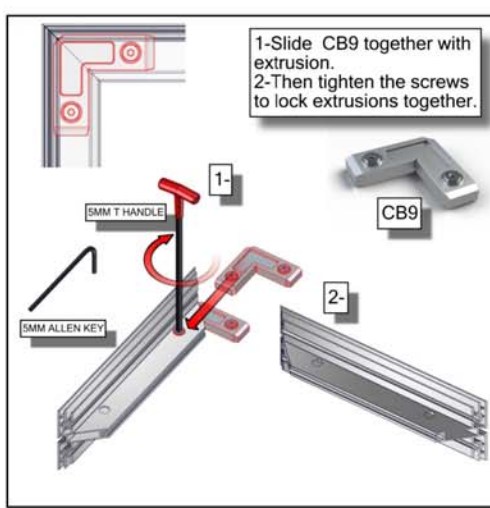

WARNING!
Locks should ONLY be turned a half (or quarter) turn so as not to STRIP the locks by over torquing them

1. Redesign of this exhibit without approval by Manufacturer may result in dangerous and unsafe structures. Manufacturer disclaims any responsibility for redesigned exhibits it does not approve in writing.

2. Parts and components such as panels and extrusions are manufactured to metric sizing. Where ever possible sizes have been noted in feet and inches as well as in metric. Below is the imperial to metric sizing table as reference. "Nominal" refers to approximate size.

ORIGIN™
EXHIBIT STRUCTURES

SECTION B

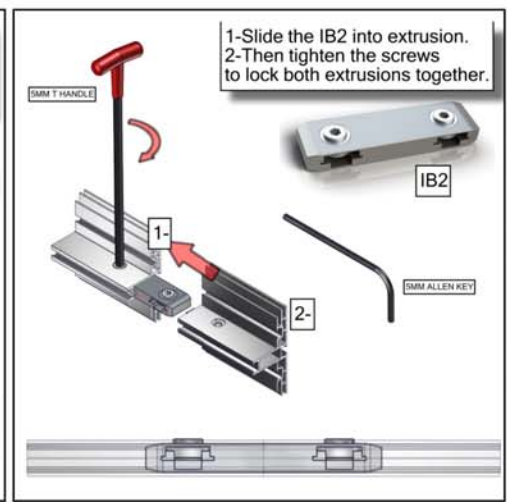
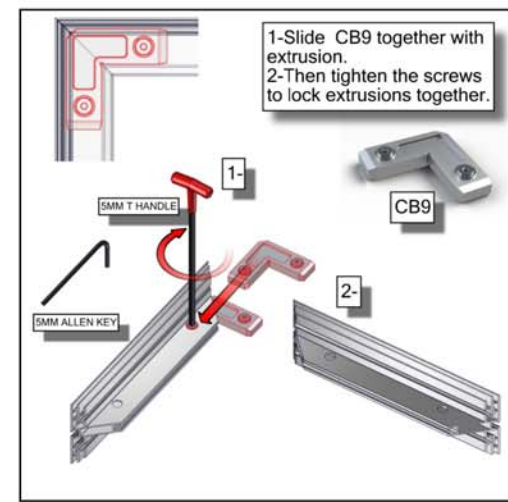
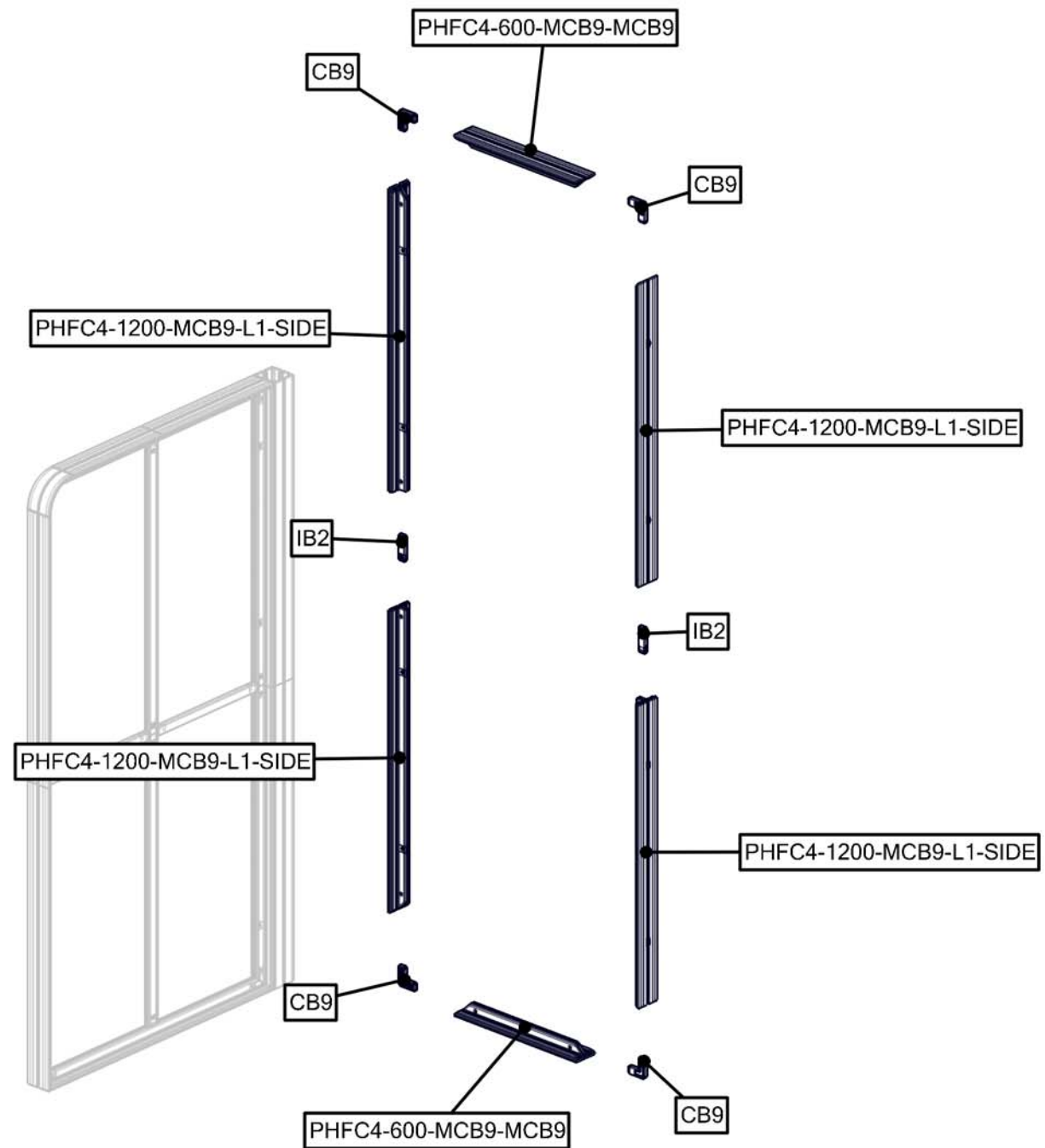

1. Redesign of this exhibit without approval by Manufacturer may result in dangerous and unsafe structures. Manufacturer disclaims any responsibility for redesigned exhibits it does not approve in writing.

2. Parts and components such as panels and extrusions are manufactured to metric sizing. Where ever possible sizes have been noted in feet and inches as well as in metric. Below is the imperial to metric sizing table as reference. "Nominal" refers to approximate size.

ORIGIN™
EXHIBIT STRUCTURES

3

SECTION D

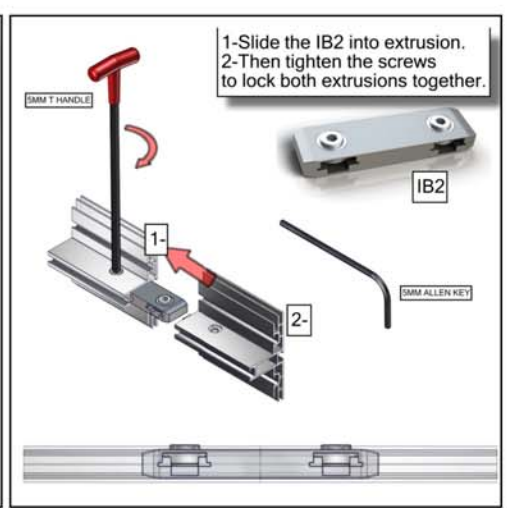
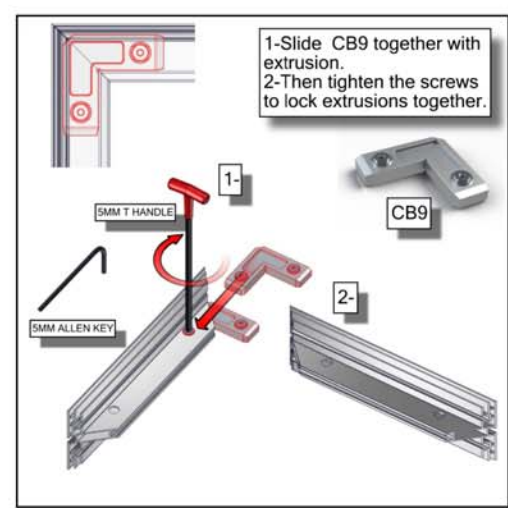
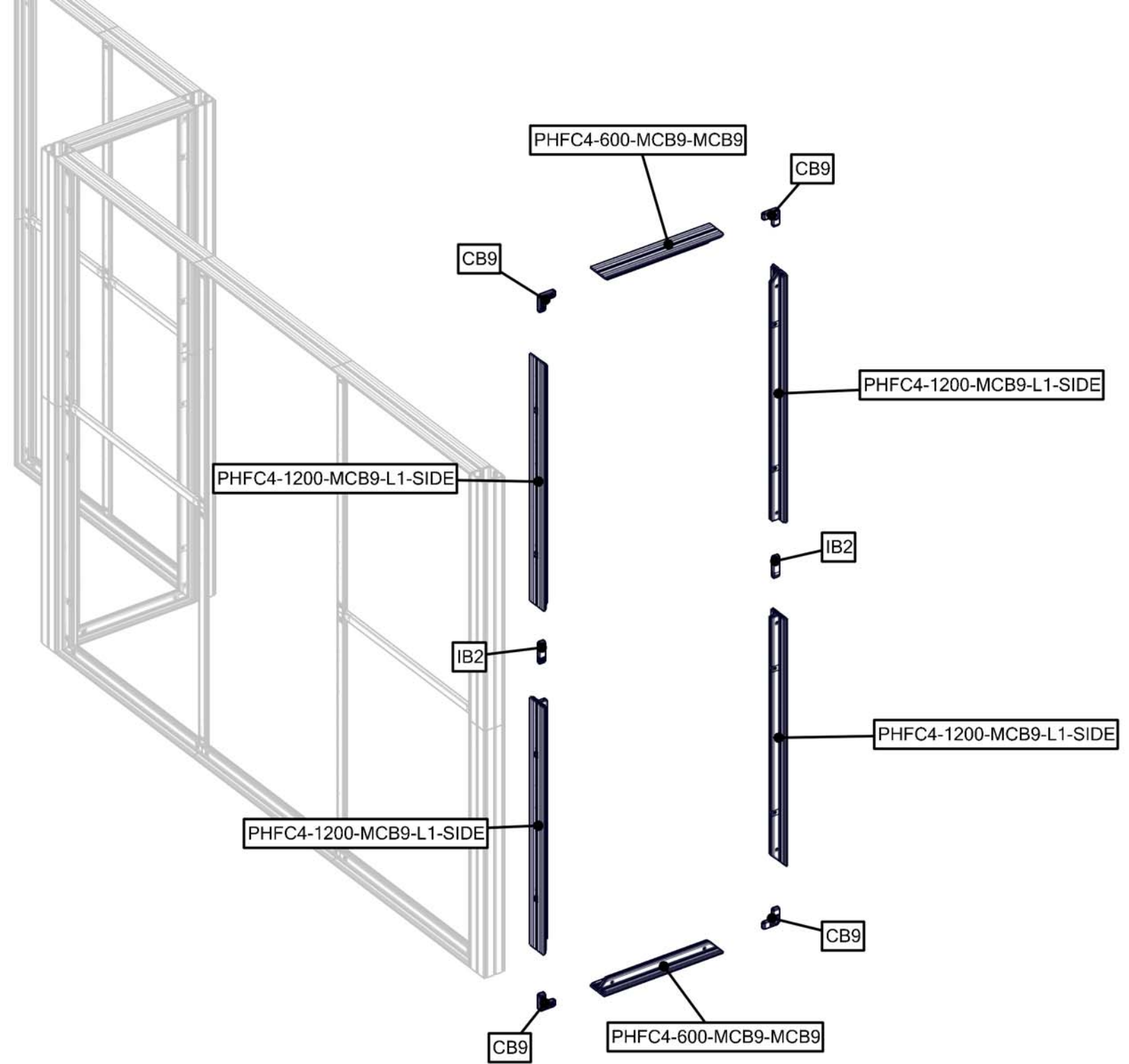

1. Redesign of this exhibit without approval by Manufacturer may result in dangerous and unsafe structures. Manufacturer disclaims any responsibility for redesigned exhibits it does not approve in writing.

2. Parts and components such as panels and extrusions are manufactured to metric sizing. Where ever possible sizes have been noted in feet and inches as well as in metric. Below is the imperial to metric sizing table as reference. "Nominal" refers to approximate size.

ASSEMBLE FRAME

SECTION E

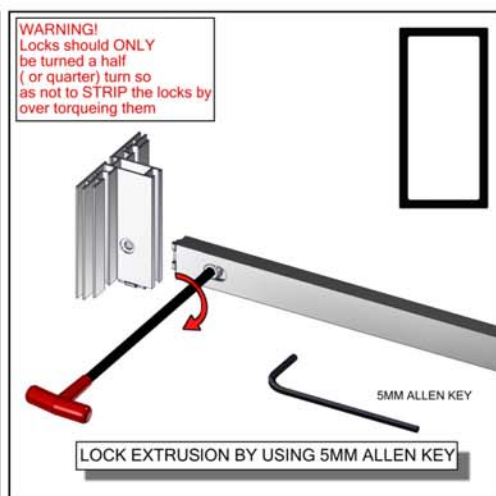
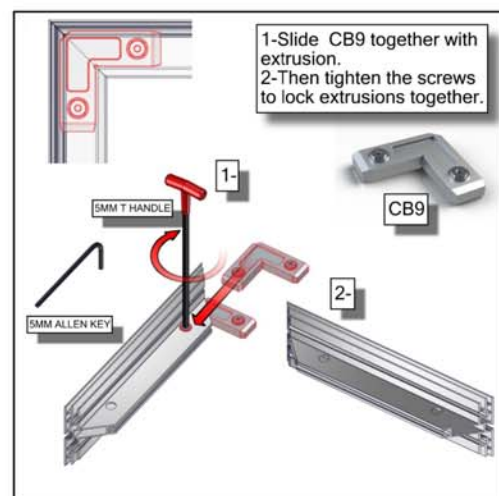
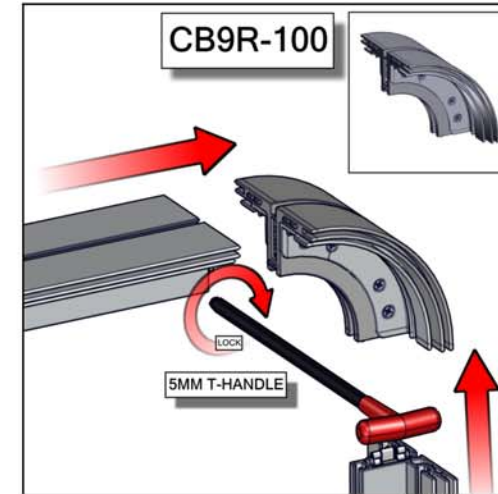
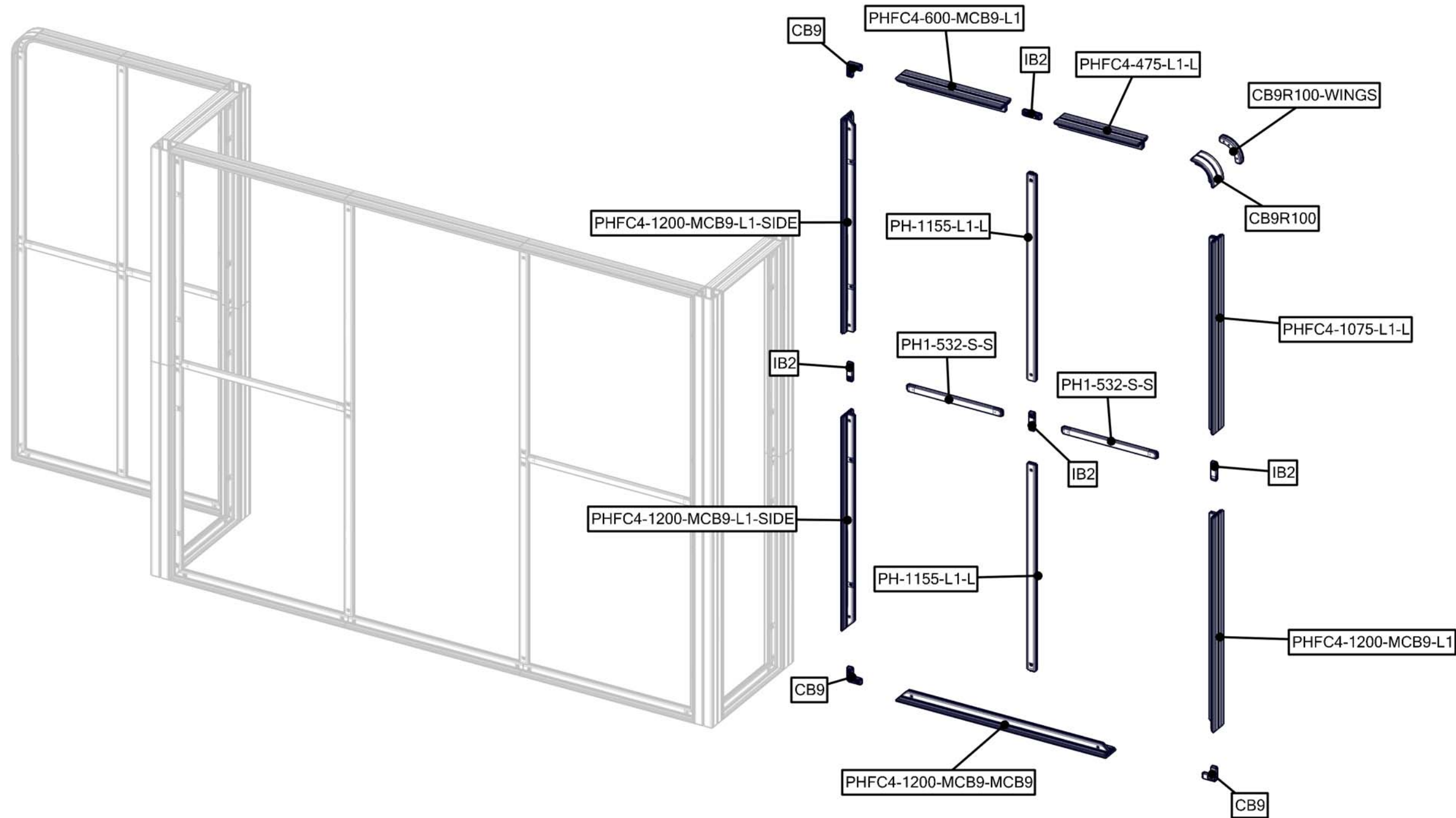

1. Redesign of this exhibit without approval by Manufacturer may result in dangerous and unsafe structures. Manufacturer disclaims any responsibility for redesigned exhibits it does not approve in writing.

2. Parts and components such as panels and extrusions are manufactured to metric sizing. Where ever possible sizes have been noted in feet and inches as well as in metric. Below is the imperial to metric sizing table as reference. "Nominal" refers to approximate size.

ORIGIN™
EXHIBIT STRUCTURES

ASSEMBLE FRAME

SECTION A,B,C,D, & E

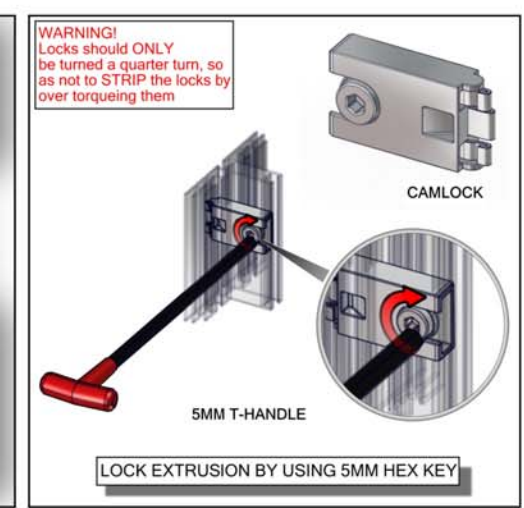
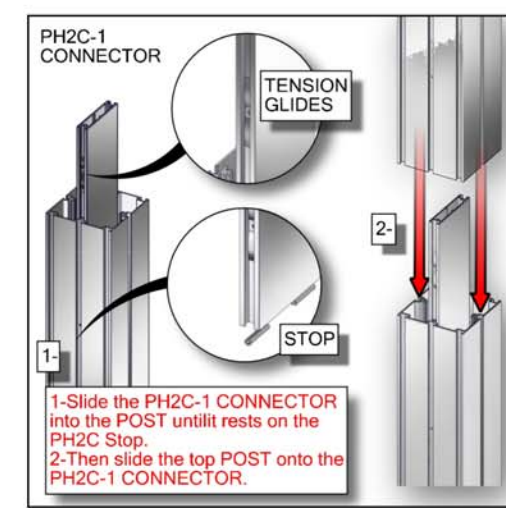
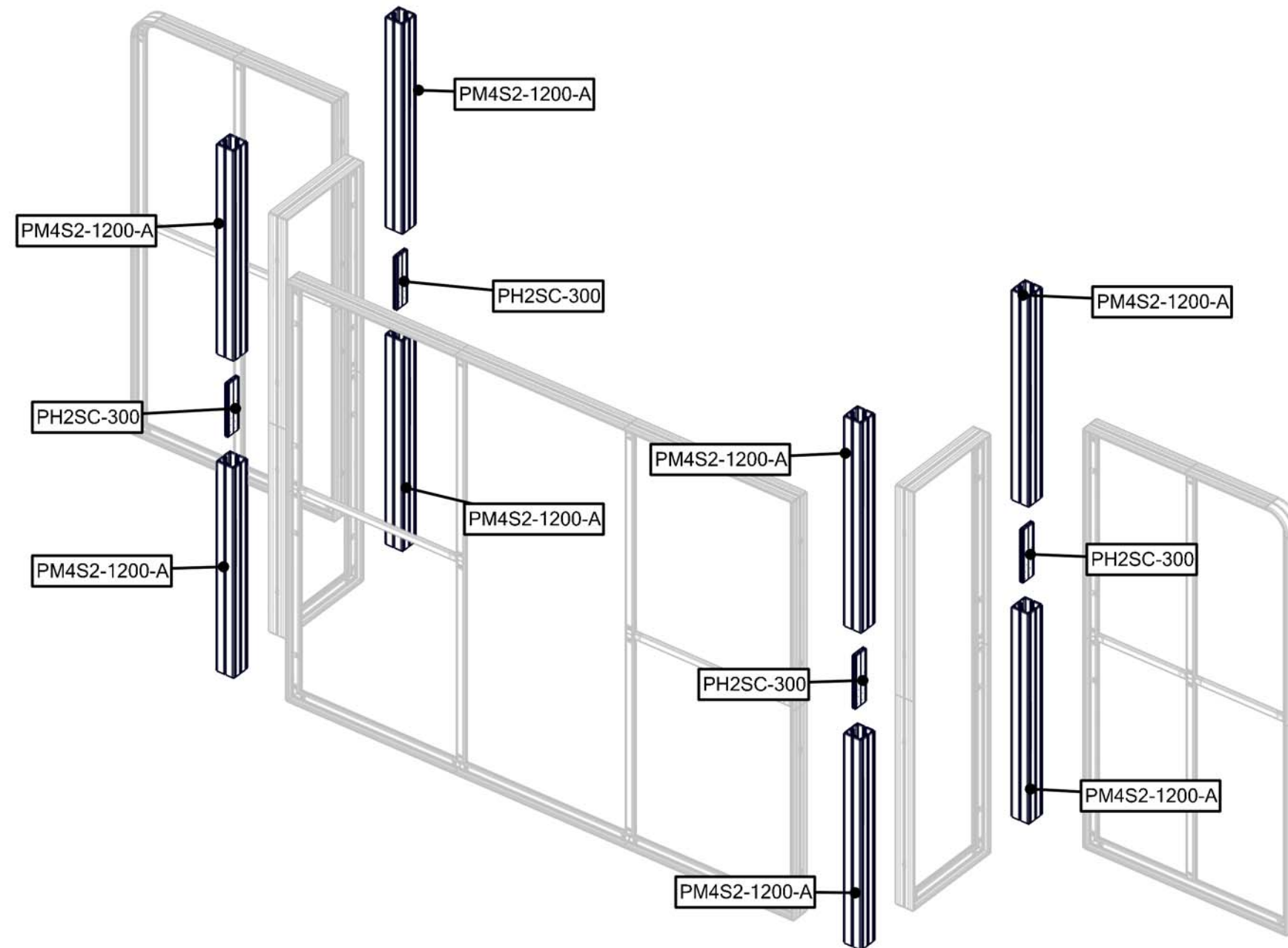

1. Redesign of this exhibit without approval by Manufacturer may result in dangerous and unsafe structures. Manufacturer disclaims any responsibility for redesigned exhibits it does not approve in writing.

2. Parts and components such as panels and extrusions are manufactured to metric sizing. Where ever possible sizes have been noted in feet and inches as well as in metric. Below is the imperial to metric sizing table as reference. "Nominal" refers to approximate size.

ORIGIN™
EXHIBIT STRUCTURES

7